

CESAB P200 1.4 - 2.5 tonne

Powered pallet trucks



Truck Specifications



CESAB P214- P216 Truck Specifications

| IDENTIFICATION | | | | |
|------------------|---|----------------------|--------------------------|--------------------------|
| 1.1 | Manufacturer | | CESAB | CESAB |
| 1.2 | Model | | P214 | P216 |
| 1.3 | Drive | | Electric | Electric |
| 1.4 | Operator type | | Pedestrian | Pedestrian |
| 1.5 | Load capacity/rated load | Q [kg] | 1400 | 1600 |
| 1.6 | Load centre | c [mm] | 600 | 600 |
| 1.8 | Load distance, centre of support arm wheel to face of forks | x [mm] | 928 | 928 |
| 1.9 | Wheelbase | y [mm] | 1260 | 1317 |
| WEIGHT | | | | |
| 2.1 | Service weight including battery | [kg] | 458 | 524 |
| 2.2 | Axle load, with load, drive/castor/fork wheel | [kg] | 590/150/1115 | 695/150/1275 |
| 2.3 | Axle load, without load, drive/castor/fork wheel | [kg] | 200/150/105 | 255/150/115 |
| WHEELS | | | | |
| 3.1 | Drive/castor/fork wheel | | Topthane/Topthane/PUR *) | Topthane/Topthane/PUR *) |
| 3.2 | Wheel size, front | [mm] | Ø230x70 | Ø230x70 |
| 3.3 | Wheel size, rear | [mm] | Ø85x100 | Ø85x100 |
| 3.4 | Additional wheels (dimensions) | [mm] | Ø125x50 | Ø125x50 |
| 3.5 | Wheels, number front/rear (x=driven wheels) | | 1x+2/2 | 1x+2/2 |
| 3.6 | Track width, front | b ₁₀ [mm] | 430 | 430 |
| 3.7 | Track width, rear | b ₁₁ [mm] | 394 | 394 |
| DIMENSIONS | | | | |
| 4.4 | Lift | h ₃ [mm] | 120 | 120 |
| | Lift height | h ₂₃ [mm] | 205 | 205 |
| 4.9 | Height of tiller in drive position, min./max. | h ₁₄ [mm] | 865/1235 | 865/1235 |
| 4.15 | Height, fork lowered | h ₁₃ [mm] | 85 | 85 |
| 4.19 | Overall length | l ₁ [mm] | 1631 | 1688 |
| 4.20 | Length to face of forks | l ₂ [mm] | 481 | 538 |
| 4.21 | Overall width | b ₁ [mm] | 726 | 726 |
| 4.22 | Fork dimensions | s/e/l [mm] | 76/156/1150 *) | 76/156/1150 *) |
| 4.25 | Width over forks | b ₅ [mm] | 550 *) | 550 *) |
| 4.32 | Ground clearance, centre of wheelbase | m ₂ [mm] | 21 | 21 |
| 4.33 | Aisle width for pallets 1000x1200 crossways | A _{st} [mm] | 1842 | 1899 |
| 4.34 | Aisle width for pallets 800x1200 lengthways | A _{st} [mm] | 1892 | 1949 |
| 4.35 | Turning radius | W _a [mm] | 1420 | 1477 |
| PERFORMANCE DATA | | | | |
| 5.1 | Travel speed, with/without load | [km/h] | 6/6 | 6/6 |
| 5.2 | Lift speed, with/without load | [m/s] | 0.04/0.05 | 0.04/0.05 |
| 5.3 | Lowering speed, with/without load | [m/s] | 0.09/0.08 | 0.09/0.08 |
| 5.8 | Max. gradeability, with/without load | [%] | 8/18 ¹⁾ | 8/18 ¹⁾ |
| 5.10 | Service brake | | Electromagnetic | Electromagnetic |
| ELECTRIC MOTOR | | | | |
| 6.1 | Drive motor rating S2 60 min | [kW] | 1.0 | 1.0 |
| 6.2 | Lift motor rating at S3 15% | [kW] | 1.0 ²⁾ | 1.0 ²⁾ |
| 6.4 | Battery voltage/nominal capacity K _s | [V/Ah] | 24/150 *) | 24/225 *) |
| 6.5 | Battery weight | [kg] | 158 | 214 |
| OTHERS | | | | |
| 8.1 | Type of drive control | | CESAB Drive Control | CESAB Drive Control |

All data are based on table configuration. Other configurations may give other values.
Truck performance and dimensions are nominal and subject to tolerances.
Specifications are subject to change without notice.

1) Measured according to company standard

2) S3 10%

*) Further alternatives are available and will produce other values.



CESAB P218 - P225 Truck Specifications

| IDENTIFICATION | | | | |
|------------------|---|----------------------|--------------------------|--------------------------|
| 1.1 | Manufacturer | | CESAB | CESAB |
| 1.2 | Model | | P218 | P220 |
| 1.3 | Drive | | Electric | Electric |
| 1.4 | Operator type | | Pedestrian | Pedestrian |
| 1.5 | Load capacity/rated load | Q [kg] | 1800 | 2000 |
| 1.6 | Load centre | c [mm] | 600 | 600 |
| 1.8 | Load distance, centre of support arm wheel to face of forks | x [mm] | 898 | 898 |
| 1.9 | Wheelbase | y [mm] | 1287 | 1287 |
| WEIGHT | | | | |
| 2.1 | Service weight including battery | [kg] | 554 | 554 |
| 2.2 | Axle load, with load, drive/castor/fork wheel | [kg] | 760/150/1435 | 815/150/1580 |
| 2.3 | Axle load, without load, drive/castor/fork wheel | [kg] | 260/150/135 | 260/150/135 |
| WHEELS | | | | |
| 3.1 | Drive/castor/fork wheel | | Topthane/Topthane/PUR *) | Topthane/Topthane/PUR *) |
| 3.2 | Wheel size, front | [mm] | Ø230x70 | Ø230x70 |
| 3.3 | Wheel size, rear | [mm] | Ø85x75 | Ø85x75 |
| 3.4 | Additional wheels (dimensions) | [mm] | Ø125x50 | Ø125x50 |
| 3.5 | Wheels, number front/rear (x=driven wheels) | | 1x+2/4 | 1x+2/4 |
| 3.6 | Track width, front | b ₁₀ [mm] | 430 | 430 |
| 3.7 | Track width, rear | b ₁₁ [mm] | 370 | 370 |
| DIMENSIONS | | | | |
| 4.4 | Lift | h ₃ [mm] | 120 | 120 |
| | Lift height | h ₂₃ [mm] | 205 | 205 |
| 4.8 | Stand height (optional platform) | h ₇ [mm] | — | 150 |
| 4.9 | Height of tiller in drive position, min./max. | h ₁₄ [mm] | 865/1235 | 865/1235 |
| 4.15 | Height, fork lowered | h ₁₃ [mm] | 85 | 85 |
| 4.19 | Overall length | l ₁ [mm] | 1688 | 1688 |
| 4.20 | Length to face of forks | l ₂ [mm] | 538 | 538 |
| 4.21 | Overall width | b ₁ [mm] | 726 | 726 |
| 4.22 | Fork dimensions | s/e/l [mm] | 78/180/1150 *) | 78/180/1150 *) |
| 4.25 | Width over forks | b ₅ [mm] | 550 *) | 550 *) |
| 4.32 | Ground clearance, centre of wheelbase | m ₂ [mm] | 21 | 21 |
| 4.33 | Aisle width for pallets 1000x1200 crossways | A _{st} [mm] | 1899 | 1899 |
| 4.34 | Aisle width for pallets 800x1200 lengthways | A _{st} [mm] | 1949 | 1949 |
| 4.35 | Turning radius | W _s [mm] | 1447 | 1447 |
| PERFORMANCE DATA | | | | |
| 5.1 | Travel speed, with/without load | [km/h] | 6/6 | 6/6 |
| 5.2 | Lift speed, with/without load | [m/s] | 0.04/0.05 | 0.06/0.09 |
| 5.3 | Lowering speed, with/without load | [m/s] | 0.09/0.08 | 0.09/0.08 |
| 5.8 | Max. gradeability, with/without load | [%] | 9/18 ¹⁾ | 9/18 ¹⁾ |
| 5.10 | Service brake | | Electromagnetic | Electromagnetic |
| ELECTRIC MOTOR | | | | |
| 6.1 | Drive motor rating S2 60 min | [kW] | 1.0 | 1.5 |
| 6.2 | Lift motor rating at S3 15% | [kW] | 1.0 ²⁾ | 1.4 ²⁾ |
| 6.4 | Battery voltage/nominal capacity K _s | [V/Ah] | 24/225 *) | 24/225 *) |
| 6.5 | Battery weight | [kg] | 214 | 214 |
| OTHERS | | | | |
| 8.1 | Type of drive control | | CESAB Drive Control | CESAB Drive Control |

All data are based on table configuration. Other configurations may give other values.
Truck performance and dimensions are nominal and subject to tolerances.
Specifications are subject to change without notice.

1) Measured according to company standard

2) S3 10%

*) Further alternatives are available and will produce other values.



CESAB P214 - P216 Dimensional Drawings

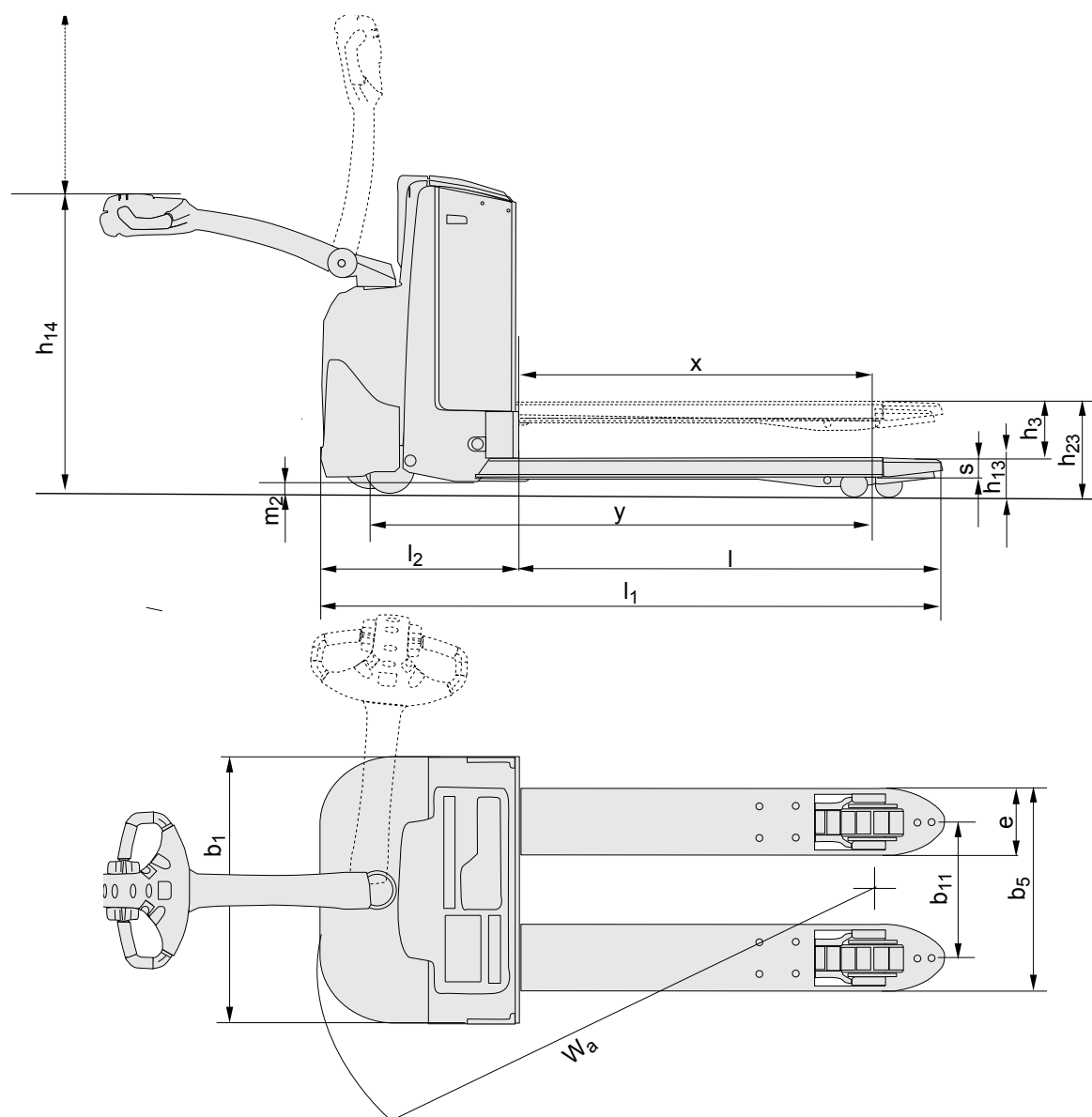

The data in this specification sheet was determined based on our standard testing conditions. Operating performance may vary depending on the actual specification and condition of the truck as well as the condition of the operating area. Availability and specifications are determined regionally and are subject to change without notice. Please consult your authorised CESAB dealership for further details. SPEC_P200_EN_2013 / P&B P200 V11 – Copyright CESAB Material Handling Europe.

Battery compartments

| | | | | | P214 | P216 | |
|---------------------|--|------------------|----------|----|----------|---------|---------|
| Battery change | | | | | Lift out | | |
| Battery compartment | | | | | Small | Small | Medium |
| 1.9 | Wheelbase | | y | mm | 1260 | 1260 | 1317 |
| 4.19 | Overall length | without platform | l_1 | mm | 1631 | 1631 | 1688 |
| | | platform up/down | l_1 | mm | - | - | - |
| 4.20 | Length to face of forks | without platform | l_2 | mm | 481 | 481 | 538 |
| | | platform up/down | l_2 | mm | - | - | - |
| 4.33 | Aisle width for pallets 1000x1200 crossways | without platform | A_{st} | mm | 1842 | 1842 | 1899 |
| | | platform up/down | A_{st} | mm | - | - | - |
| 4.34 | Aisle width for pallets 800x1200 lengthways | without platform | A_{st} | mm | 1892 | 1892 | 1949 |
| | | platform up/down | A_{st} | mm | - | - | - |
| 4.35 | Turning radius | without platform | W_a | mm | 1420 | 1420 | 1477 |
| | | platform up/down | W_a | mm | - | - | - |
| 6.4 | Battery voltage, nominal capacity K_5 | | V/Ah | | 24/150 | 24/150 | 24/225 |
| 6.5 | Battery weight, min.-max. | | kg | | 120—165 | 120—165 | 180—220 |

CESAB P218 - P225 Dimensional Drawings

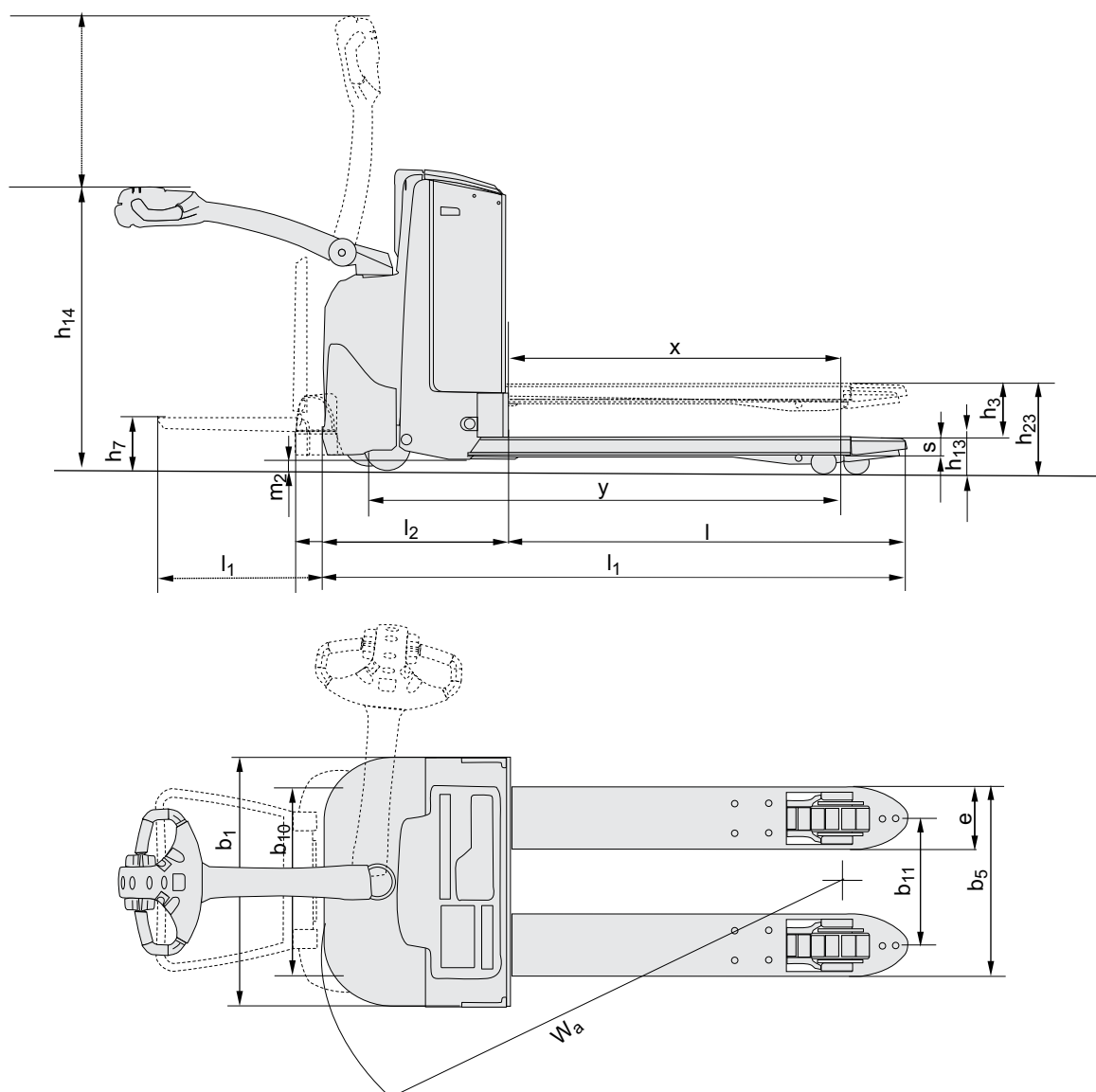

The data in this specification sheet was determined based on our standard testing conditions. Operating performance may vary depending on the actual specification and condition of the truck as well as the condition of the operating area. Availability and specifications are determined regionally and are subject to change without notice. Please consult your authorised CESAB dealership for further details. SPEC_P200_EN_2013 / P&B P200 V11 - Copyright CESAB Material Handling Europe.

Battery compartments

| | | | | P218 | | P220 | | | P225 | | |
|---------------------|---|------------------|-------------|----------|---------|-----------|-----------|-----------|----------|---------|---------|
| Battery change | | | | Lift out | | Lift out | | | Lift out | | |
| Battery compartment | | | | Medium | Large | Medium | Large | Large | Medium | Large | Large |
| 1.9 | Wheelbase | | y mm | 1287 | 1337 | 1287 | 1337 | 1337 | 1287 | 1337 | 1337 |
| 4.19 | Overall length | without platform | l_1 mm | 1688 | 1738 | 1688 | 1738 | 1738 | 1688 | 1738 | 1738 |
| | | platform up/down | l_1 mm | - | - | 1773/2163 | 1823/2213 | 1823/2213 | - | - | - |
| 4.20 | Length to face of forks | without platform | l_2 mm | 538 | 588 | 538 | 588 | 588 | 538 | 588 | 588 |
| | | platform up/down | l_2 mm | - | - | 623/1013 | 673/1063 | 673/1063 | - | - | - |
| 4.33 | Aisle width for pallets 1000x1200 crossways | without platform | A_{st} mm | 1899 | 1948 | 1899 | 1948 | 1948 | 1899 | 1948 | 1948 |
| | | platform up/down | A_{st} mm | - | - | 1984/2384 | 2033/2433 | 2033/2433 | - | - | - |
| 4.34 | Aisle width for pallets 800x1200 lengthways | without platform | A_{st} mm | 1949 | 1998 | 1949 | 1998 | 1998 | 1949 | 1998 | 1998 |
| | | platform up/down | A_{st} mm | - | - | 2034/2434 | 2083/2483 | 2083/2483 | - | - | - |
| 4.35 | Turning radius | without platform | W_a mm | 1447 | 1496 | 1447 | 1496 | 1496 | 1447 | 1496 | 1496 |
| | | platform up/down | W_a mm | - | - | 1532/1932 | 1581/1981 | 1581/1981 | - | - | - |
| 6.4 | Battery voltage, nominal capacity K_6 | | V/Ah | 24/225 | 24/300 | 24/225 | 24/300 | 24/260 | 24/225 | 24/300 | 24/260 |
| 6.5 | Battery weight, min.-max. | | kg | 180-220 | 220-270 | 180-220 | 220-270 | 220-230 | 180-220 | 220-270 | 220-230 |

The data in this specification sheet was determined based on our standard testing conditions. Operating performance may vary depending on the actual specification and condition of the truck as well as the condition of the operating area. Availability and specifications are determined regionally and are subject to change without notice. Please consult your authorised CESAB dealership for further details. SPEC_P200_EN_2013 / P&B P200 V11 – Copyright CESAB Material Handling Europe.

