

CESAB P100 1.3 tonne

Powered pallet truck

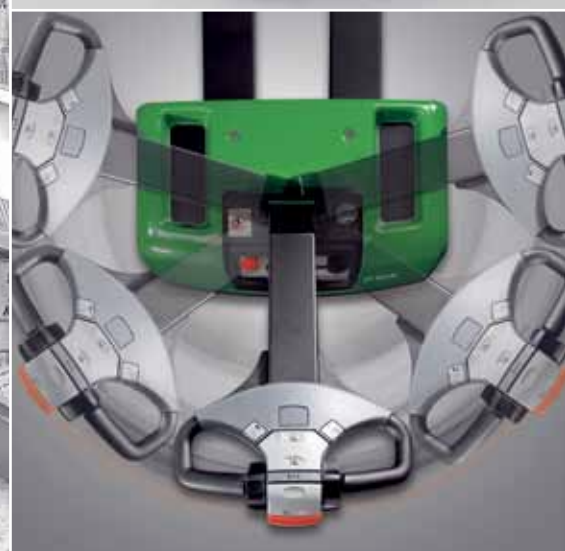

Truck Specifications



CESAB P113 Truck Specifications

CHARACTERISTICS			
1.1	Manufacturer		CESAB
1.2	Model		P113
1.3	Drive		Electric
1.4	Operator type		Pedestrian
1.5	Load capacity/rated load	Q [kg]	1300
1.6	Load centre	c [mm]	600
1.8	Load distance, centre of support arm wheel to face of forks	x [mm]	937
1.9	Wheelbase	y [mm]	1199
WEIGHT			
2.1	Service weight including battery	[kg]	246
2.2	Axle load, with load, drive/castor/fork wheel	[kg]	570/60/992
2.3	Axle load, without load, drive/castor/fork wheel	[kg]	175/48/36
WHEELS			
3.1	Drive/castor/fork wheel		Tractothan/PU/PU
3.2	Wheel size, front	[mm]	Ø250x60
3.3	Wheel size, rear	[mm]	Ø85
3.4	Additional wheels (dimensions)	[mm]	Ø100x40
3.5	Wheels, number front/rear (x=driven wheels)		2-1x/2
3.6	Track width, front	b ₁₀ [mm]	480
3.7	Track width, rear	b ₁₁ [mm]	364
DIMENSIONS			
4.4	Lift	h ₃ [mm]	120
	Lift height	h ₂₃ [mm]	205
4.9	Height of tiller in drive position, min./max.	h ₁₄ [mm]	788/1270
4.15	Height, fork lowered	h ₁₃ [mm]	85
4.19	Overall length	l ₁ [mm]	1570
4.20	Length to face of forks	l ₂ [mm]	420
4.21	Overall width	b ₁ [mm]	700
4.22	Fork dimensions	s/e/l [mm]	76/156/1150
4.25	Width over forks	b ₅ [mm]	520
4.32	Ground clearance, centre of wheelbase	m ₂ [mm]	34
4.33	Aisle width for pallets 1000x1200 crossways	A _{st} [mm]	1673
4.34	Aisle width for pallets 800x1200 lengthways	A _{st} [mm]	1873
4.35	Turning radius	W _a [mm]	1410
PERFORMANCE DATA			
5.1	Travel speed, with/without load	[km/h]	4/5,5
5.2	Lift speed, with/without load	[m/s]	0,04/0,07
5.3	Lowering speed, with/without load	[m/s]	0,04/0,04
5.8	Max. gradeability, with/without load	[%]	5/10 ¹⁾
5.10	Service brake		Electromagnetic
ELECTRIC MOTOR			
6.1	Drive motor rating S2 60 min	[kW]	0,5
6.2	Lift motor rating at S3 15%	[kW]	1,2 ²⁾
6.4	Battery voltage/nominal capacity K _s	[V/Ah]	2x12/63
6.5	Battery weight	[kg]	2x23
OTHERS			
8.1	Type of drive control		Transistor, stepless
8.4	Sound level at the driver's ear according to EN 12 053	[dB(A)]	66

Truck performance and dimensions are nominal and subject to tolerances.
Specifications are subject to change without notice.

1) Measured according to company standard

2) S3 4.5%



CESAB P113 Dimensional Drawings

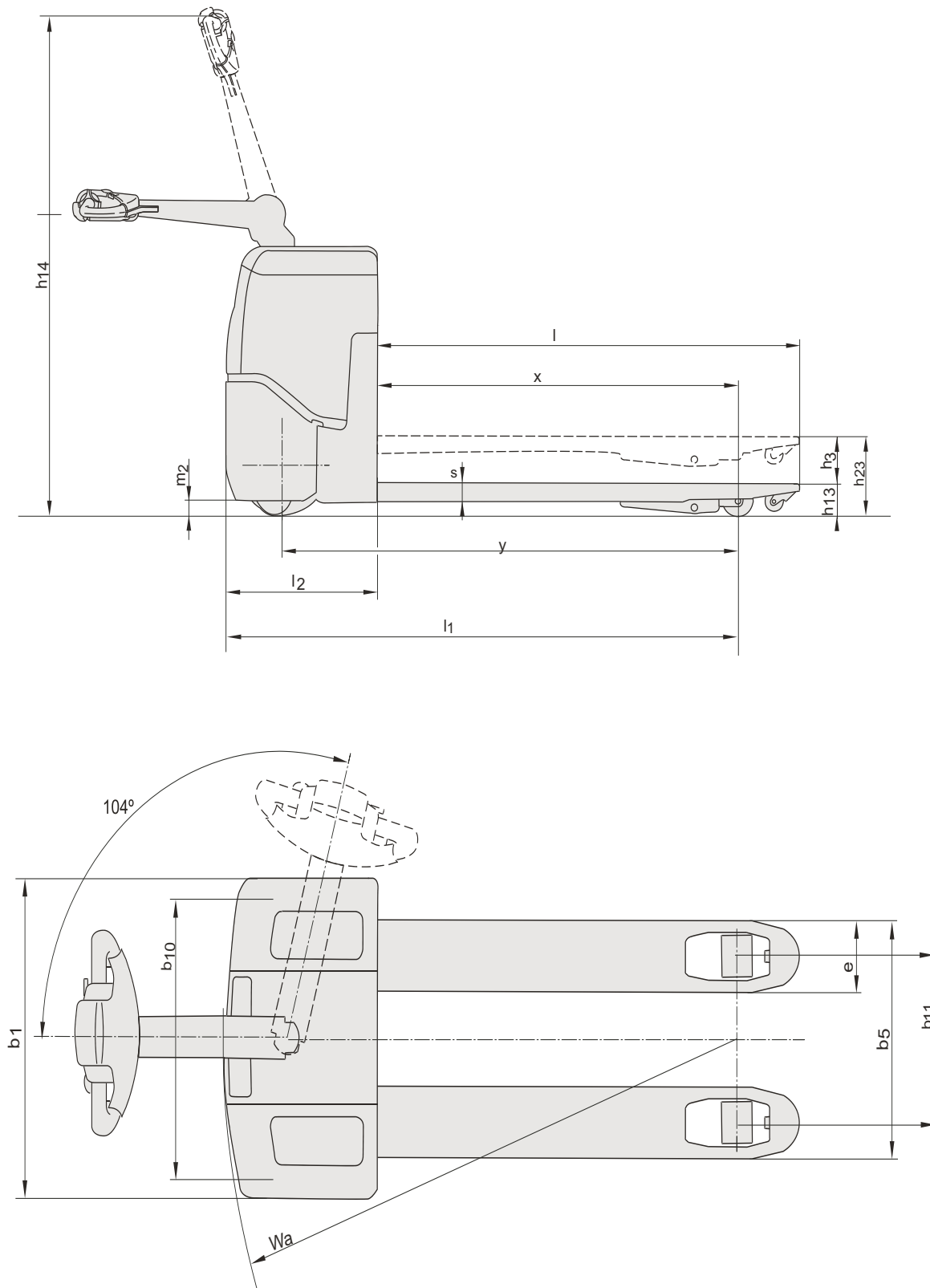

Availability and specifications are determined regionally and are subject to change without notice.
Please consult your authorised CESAB distributor for further details. P&B-0510 P100/S1.0/MAY 10.

Availability and specifications are determined regionally and are subject to change without notice.
Please consult your authorised CESAB distributor for further details. P&B-0510 P100/S1.0/MAY 10.

